



EV Charging Solution

DC Charger / City Charger 200kW

- 200kW fast charging with ≥ 96 % efficiency
- Complete system integration for better charging services
- Advanced service support for optimal operation



Highway
Service



Parking



Service
Station



Commercial
Areas



Traffic
Hub



Speed up Urban Life with EV Fast Charging

Delta City Charger 200kW provides high-efficiency charging service for EV charging stations. With dual outputs and dynamic load distribution, it can serve 2 EVs simultaneously, which boosts the turnover at the charging station. Its industry-leading $\geq 96\%$ efficiency

performance saves energy significantly. It is also compatible with OCPP, allowing backend integration, such as user identification, remote monitoring and control.



Application Scenario

Charging Network

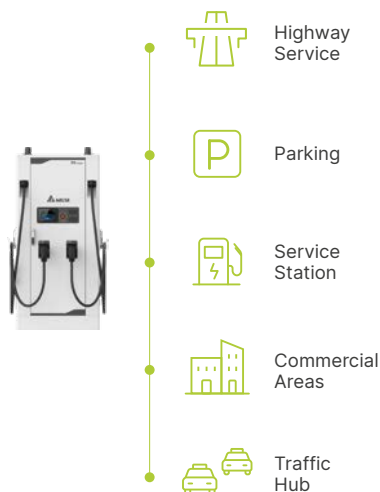

Backend Office

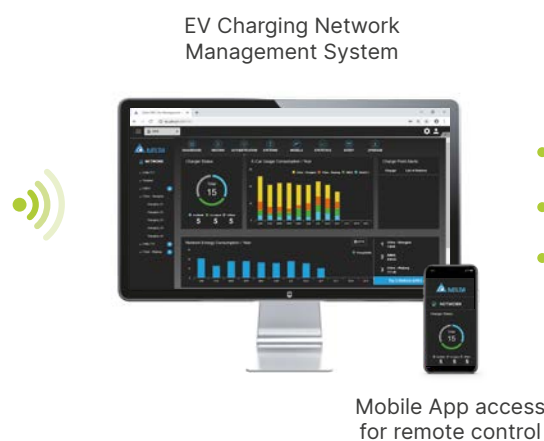

Applications

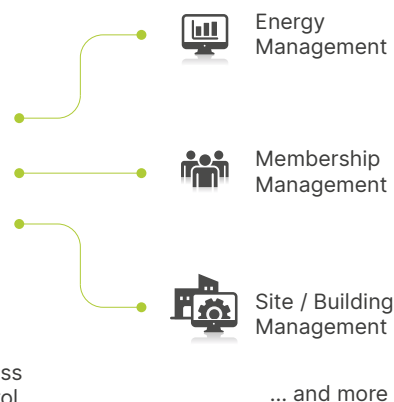

Feature Highlights



200kW fast charging
with $\geq 96\%$ efficiency

- Up to 200kW output per connector
- Charge two vehicles simultaneously with max. 200kW output
- Dynamic load distribution optimizes charging services



Complete system integration
for better charging services

- Supports OCPP 1.6J for backend office integration
- RFID and credit card reader conducts user identification and payment transactions



Advanced service
support for optimal operation

- Supports remote diagnostics channel and alarm code synchronization
- Supports OTA firmware updates
- Remote troubleshooting instruction

Product at a Glance

Network Connectivity
Ethernet, Cellular, WLAN

User Authentication
Credit card, RFID reader,
ISO 15118 PnC*

Charging Standard
CCS2

Protection
IP55, IK10

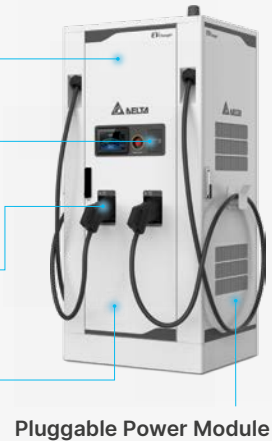

Pluggable Power Module

Cable Management

Balancing System for City Charger

A pair of balancing system stands is needed to manage the charging cables of dual-connector models. The design utilizes the weight stacks, paracord, and pulleys to balance the pull force on the charging cable. It provides a better user experience by helping the users hold the cable, move the charging cable, and return the charging cable more easily. In addition, the mechanism holds the cable so that it will be well organized instead of lying on the ground.

On-side Installation

Front side Installation

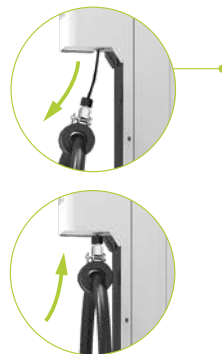

Balancing system for helping
users hold and move charging cable easier.

Specifications

| Part Number | EIDS-E200TS | EIDS-E150TS |
|-----------------------|--|------------------------------|
| Description | 200kW Dual Output DC Charger | 150kW Dual Output DC Charger |
| Power Input | | |
| Input Rating | 380 - 415 Vac, 3-Phase, L1, L2, L3, PE, 50 / 60 Hz | |
| Power Factor | 0.99 | |
| Efficiency | ≥ 96 % | |
| Power Output | | |
| DC Output Interface | CCS2 + CCS2 | |
| DC Output Voltage | 150 - 950 Vdc | |
| DC Output Current | 300 A, peak 400 A | |
| Protection | | |
| Protection | Over current, Under voltage, Over voltage, Surge protection, Short circuit, Over temperature, Ground fault | |
| User Interface | | |
| Network Interface | Ethernet, Cellular, WLAN | |
| Protocol | Backend system integration with OCPP 1.6 | |
| Authentication | ISO / IEC 14443 A / B RFID, Credit card reader (Optional) | |
| Display | 7 inch touch LCD panel | |
| Supported Language | English (Additional languages available on request) | |
| Button | Emergency button | |
| Environmental | | |
| Operating Temperature | Operating from -30 °C to +40 °C, de-rating from +40 °C to +50 °C | |
| Storage Temperature | -40 °C to +85 °C | |
| Humidity | < 95 % relative humidity, non-condensing | |
| Altitude | 2,000 m | |
| Mechanical | | |
| Ingress Protection | IP55 | |
| Enclosure Protection | IK10 according to IEC 62262 | |
| Cooling | Forced air | |
| Dimension (W x H x D) | 850 × 1800 × 680 mm | |
| Weight ** | 420 kg | 400 kg |
| Cable Length | 4 m (Standard), 7 m (Optional) | |
| Regulation | | |
| Certificate | IEC 61851-23, CE | |
| Installation | | |
| Accessory | Cable management | |

* ISO 15118 PnC and OCPP 2.0 in plan.

** Excluding charging connector cable.

Product outlook depends on configuration. Specifications are subject to change without notice.

| Item | Cable Management |
|-------------------------|---|
| Manageable cable length | 4 m |
| Placement | Front sides of charger, on-site installation |
| Dimension (W x D x H) | 110 × 235 × 1800 mm, 32 kg |
| Recoiler cable length | 2.6 m with paracord inside |
| Internal counterweight | Depending on the weight of the charging cable |



More information

Delta Electronics (Netherlands) BV

Zandsteen 15, 2132 MZ Hoofddorp,
The Netherlands
TEL : +31 20 655-0900

evcharging.deltawww.com

Delta Electronics Inc.

16 Tungyuan Road, Chungli Industrial
Zone, Taoyuan City 32063, Taiwan
TEL : +886 3 4526107



2022/04